

## Basic Instructions

### ● Contents & Part names

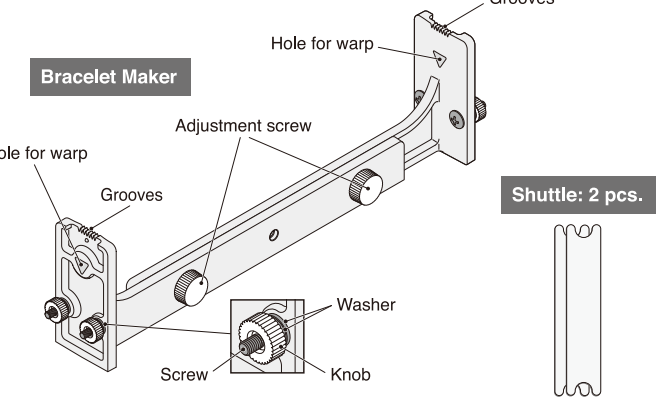

### ● What you'll need:

- Thread for the warp, making knots or weaving
    - Embroidery thread No. 25 & No. 5, lace yarn, woolen yarn of medium thickness, etc.
    - Strong, non-elastic and hard to break thread is suitable.
    - You can also use sewing thread, hand sewing thread, etc. for delicate work.
  - Tapestry needle   ○ Beading needle   ○ Threader
  - Measuring tape or Ruler   ○ Scissors   ○ Adhesive tape or Masking tape
- 
- When using beads: sewing thread (you will need it to thread beads)
  - When you create using ladder stitching: beads, use nylon beading thread

### ● About the finished bracelet length.

- Approximate length of Part-A = length around the wrist + 5/8 in. (1.5 cm)
- Length of Part-B = 2 ~ 3-1/4 in. (5 ~ 8 cm)

(Part-B will be made with the rest of the warp after making Part-A. The finished length will change depending on techniques, the type and number of thread you use, and how you make knots or weave.)

You can make your favorite bracelet combining the techniques you choose for each of Part-A and B.  
 For more details, please read the QR code on the right side.

### ● You can change the length of Part-A using the adjustment screw.

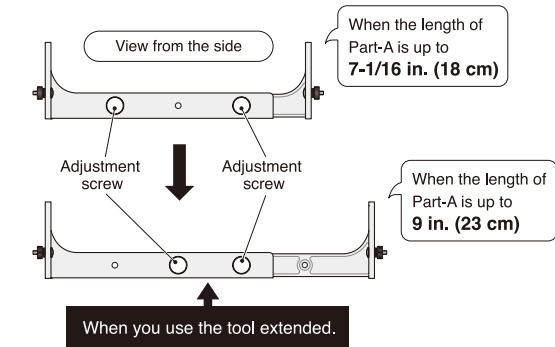

**Cautions** ● Do not use for any purpose other than intended. ● If you force the tool too much, it may damage it. ● Keep out of reach of children.

Read the QR code for techniques on how to make the bracelet.



▲ U.S.A. website

## Making the Bracelet

Choose the length of the bracelet, the type and number of threads, and technique according to the bracelet you want to make.

Make Part-A first, and then Part-B. You can use "knotting", "weaving" and "ladder stitching" techniques for Part-A. The way of warping is different for "making knots" and "weaving/ladder stitching".

### 1 How to make Part-A — When you use knotting technique —

— These instructions are for a bracelet with 6-1/8 in. (15.5 cm) length for Part-A using the "Larks Head Knot" technique.

- Warp: embroidery thread No. 25 (6 strands), 19-5/8 in. (50 cm) × 2  
 When you use the Bracelet Maker body extended, prepare a warp 2 in. (5 cm) longer.
- ★ Depending on which knot technique you use, the length of the warp per strand will be the same.
- Thread for making knots: embroidery thread No. 25 (6 strands), 2.2 yds. (2 m) × 1  
 The length of the thread for making knots will change depending on the length of Part-A, techniques, the type and number of threads you use, and how you make knots.

#### 1. Fix the warp to the knob.

Loosen either right or left knob in front of you. Wrap once 2 strands of warps together around the screw as shown in the illustration. Tighten the knob leaving 4 in. (10 cm) of thread end.

▼ View from the top

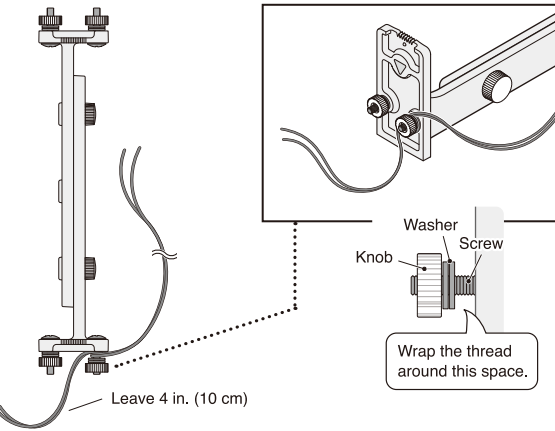

#### 2. Set the warp.

Pass the warp through the hole for warp and fix the other end of the warp the same way as in Step 1, keeping the warp stretched.

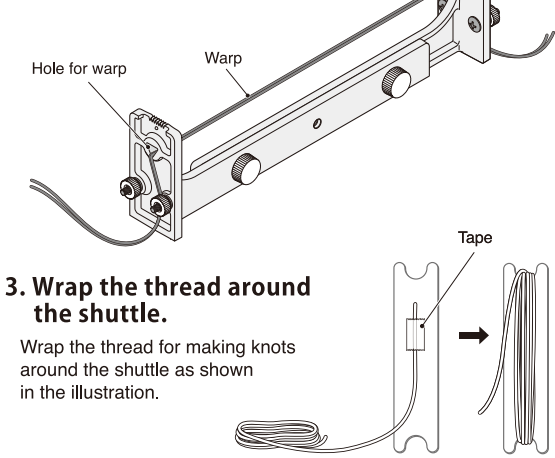

#### 3. Wrap the thread around the shuttle.

Wrap the thread for making knots around the shuttle as shown in the illustration.

#### 4. Make Part-A.

Tie the thread for making knots wrapped around the shuttle with the warp. Make a knot from the other side to your side.

- As shown in the illustration, when you start, make a knot at about 3/8 in. (1 cm) from the end of the warp, leaving 5-7/8 in. (15 cm) thread end.
- Make Larks Head Knot.  
 (→ Read the QR code and see "Part-A/② Larks Head Knot" for your reference)
- Continue making knots until the length of the knotted part is 6-1/8 in. (15.5 cm). When it is difficult to pass the shuttle, remove the thread from the shuttle and make knots.
- To finish making knots, cut the thread end leaving 5-7/8 in. (15 cm) and tie it with the warp.

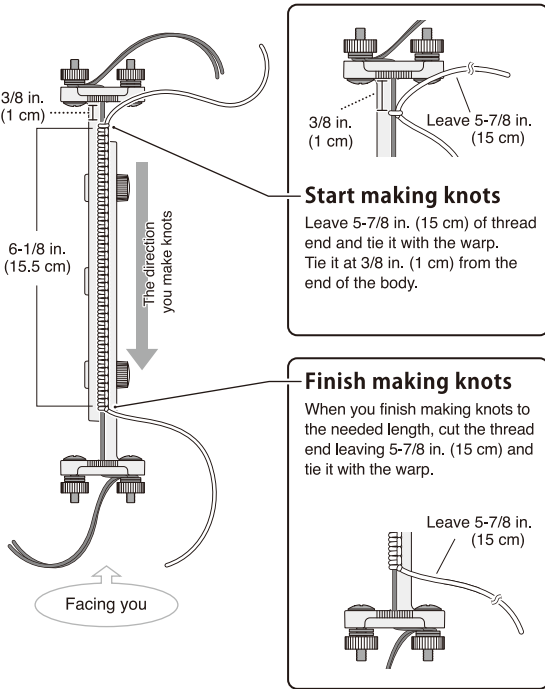

### 2 How to make Part-A — When you use weaving/ladder stitching techniques —

— These instructions are for a bracelet with 6-1/8 in. (15.5 cm) length for Part-A using the weaving technique (with 5 warps) .

- Warp: embroidery thread No. 25 (6 strands), 21-5/8 in. (55 cm) × 5  
 When you use the Bracelet Maker body extended, prepare a warp 2 in. (5 cm) longer.
- ★ Whichever weaving or ladder stitching technique you use, the length of the warp per strand will be the same.
- Thread for weaving: embroidery thread No. 25 (6 strands), 3.3 yds. (3 m) × 1  
 The length of the thread for weaving will change depending on the length of Part-A, the techniques, the type and number of threads you use, and how you weave.

#### 1. Fix the warp to the knob.

Loosen both knobs in front of you. As shown in the illustration, divide the warps into two sets of 2 and 3 strands. Wrap each set around the screw once. Tighten the knob leaving 4 in. (10 cm) of thread end.

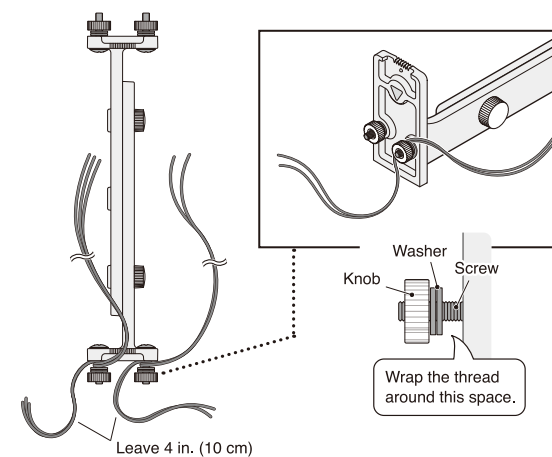

#### 2. Set the warp.

Insert the warp one by one into the grooves. Put the warps on the other side of concave grooves to prevent the warps from overlapping or squeezing. Fix the end of the warp the same way as in Step 1 keeping the warp stretched.

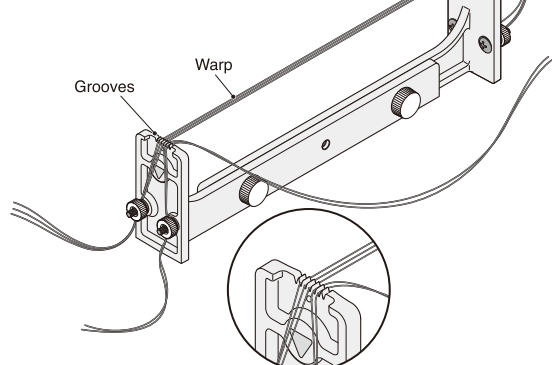

#### 3. Wrap the thread around the shuttle. (→ See 1 - Step 3)

#### 4. Make Part-A.

Pass the thread for weaving wrapped on the shuttle through the warp. Weave from your side to the other side.

- As shown in the illustration, when you start weaving, tie it at about 3/8 in. (1 cm) from the end of the warp leaving 5-7/8 in. (15 cm) thread end.
- Continue weaving.  
 (→ Read the QR code and see "Part-A/① Basic Weaving" for your reference)
- Continue weaving until the length of the woven part is 6-1/8 in. (15.5 cm). When it is difficult to pass the shuttle, remove the thread from the shuttle and pass the thread using a tapestry needle.
- To finish weaving, cut the thread end leaving 5-7/8 in. (15 cm) and tie it with the warp at the end.

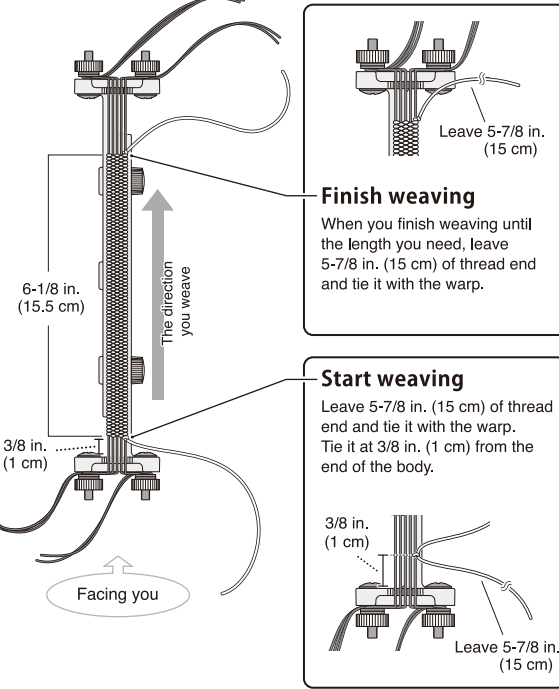

## 3 How to make Part-B

You can make Part-B using Rope Braid, Three Strand Braid and Four Strand Braid.  
 (→ Read the QR code and see "Part-B" for your reference)

- Remove the bracelet from the Bracelet Maker.  
 Fix the end of Part-A you made with tape to your work surface.
- When you finish weaving Part-B to the needed length, tie the ends together.
- Do the same with the other side.

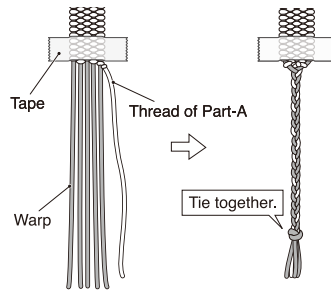

When you make Part-B only with warps, pass the thread end of A through Part-A and finish the thread.  
 (→ See "How to finish the thread" below)

### ● How to change the thread

**When you want to change the thread or add thread in the middle of weaving:**

Make sure that the end of the previous thread is at least 5-7/8 in. (15 cm) and start weaving leaving 5-7/8 in. (15 cm) or longer on the new thread, and continue weaving. Leave the end of the thread as it is without tying it and finish the thread together at the end.  
 (→ See "How to finish the thread" below)

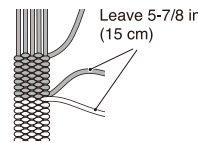

### ● How to finish the thread

**If you changed the thread in the middle, finish the thread using a tapestry needle.**

Pass the thread end through tapestry needle. Pass it through Part-A, insert it along the warp to hide. Repeat, hiding about 1-1/4 in. (3 cm), cut the thread end.

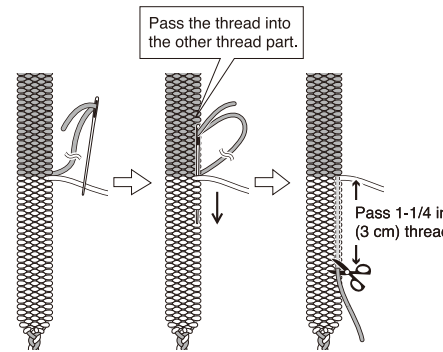

### ● When you put beads, etc. onto the thread

**For putting beads, etc. onto thread for making knots and weaving:**

Pass the beads or other kinds of parts through the thread for making knots or weaving beforehand. Making Part-A parts, pull the beads at the desired point.

★ You can do it this way with all techniques except ladder stitching.

**For putting beads, etc. onto the warp:**

- Before you set the warp, pass the beads or other parts through the warp.
- Pull the beads at the desired point and make a knot.
- When you need more beads, loosen the knob in front of you, remove the warp and add beads.

★ You can do it this way with all techniques except weaving/ladder stitching.

